

Microwave Farm's terminations are composed of broadband, due to the coaxial construction, It offers a excellent performance specified from DC to 18 GHz Precision SMA coaxial connector interfaces ensure an good impedance match across wide bandwidth.



■ Features

- DC to 18 GHz
- Power rating : 2 W @ 25~70 °C
- Temperature range : -55 ~ 100 °C

■ Specification

Scope	Specification	MFTM06-02-01F
Electrical	Impedance(Ohm)	50
	Freq. range (GHz)	DC to 18
	Power rating	2 W @ 25~70 °C
Material	Dielectric	PTFE
	Center Contact	Beryllium copper with gold plated
	Body & Connector	Stainless steel (Passivated)

Freq.	V.S.W.R			
	DC-4 GHz	4-8 GHz	8-12 GHz	12-18 GHz
TM06-02-01F	1.07	1.10	1.15	1.20

■ Drawing

Part No. : MFTM06-02-01F

Unit : mm

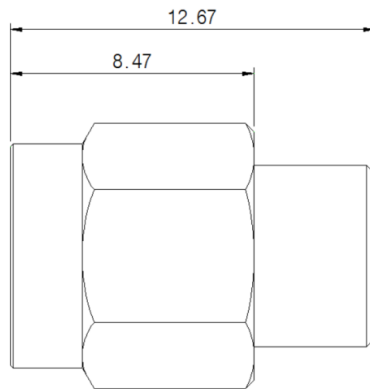

■ Measurement result

- Freq. range : 10 MHz to 18 GHz

